

# HOW TO TAKE MEASUREMENTS FOR DOOR HANDLES AND DOOR FITTINGS

Also online in: [documents.sensorberg.com](https://documents.sensorberg.com)

For more info: [support@sensorberg.com](mailto:support@sensorberg.com) | +49 30 275 830 21

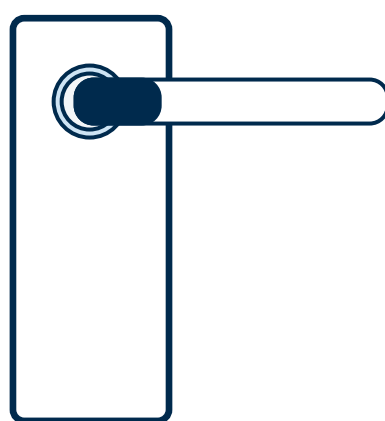

## BEFORE YOU START...

- Ask your door builder or landlord for the information of every door from STEP 1 to 10.
- If not available, follow STEP 1 to 10 on your own for all of your doors. You can call Sensorberg for help if needed.

STEP 1

Provide the direction of the door handle on the *restricted side* (outside, electrical side) and take note if it is pointing left or right.

It is not necessary to provide the direction of the *mechanical side* (inside).

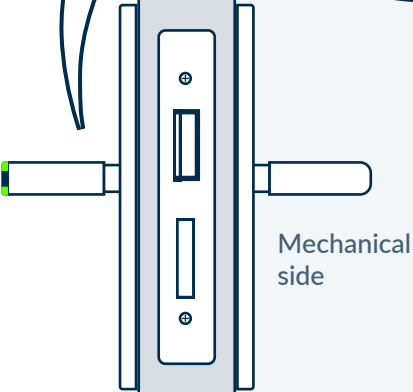
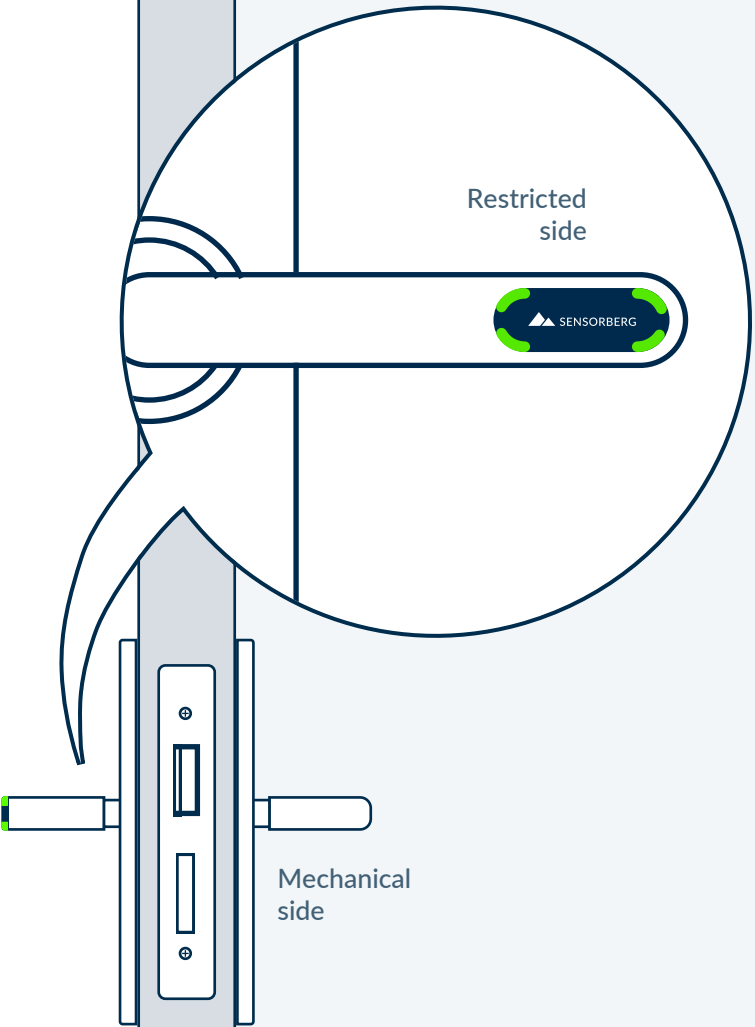
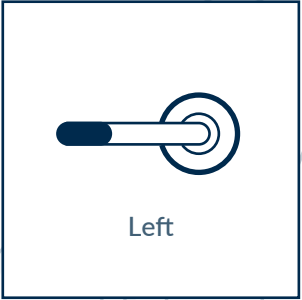
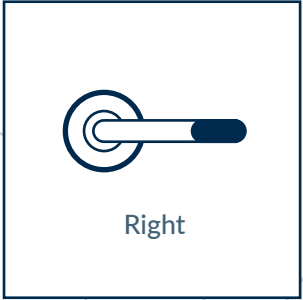

OUTSIDE

INSIDE

STEP 2

Provide the type of door fitting.

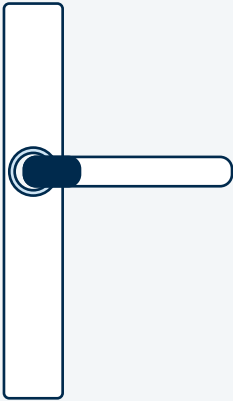
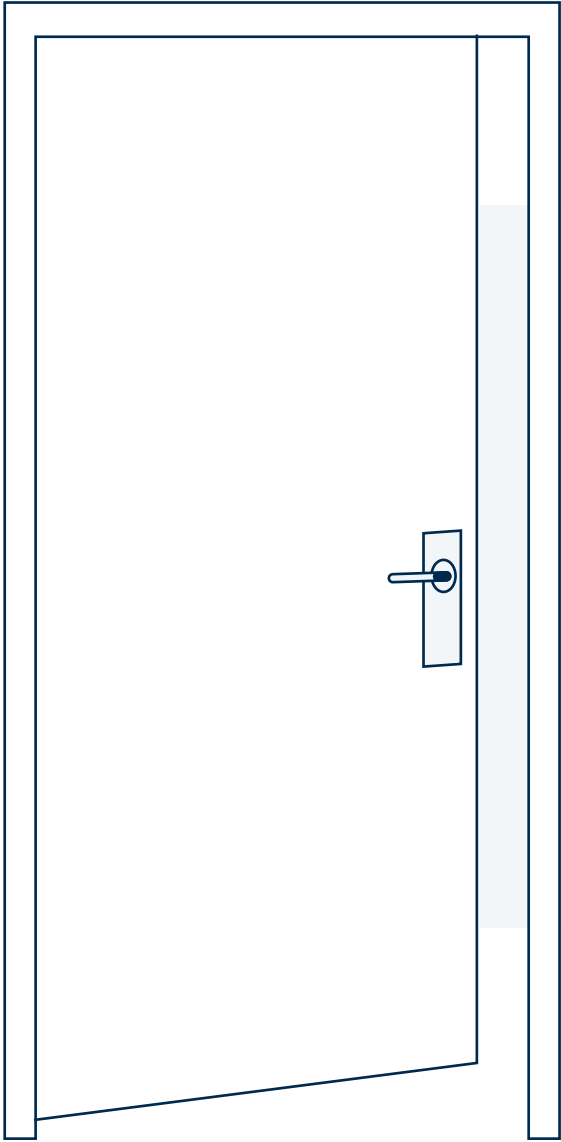

Slim

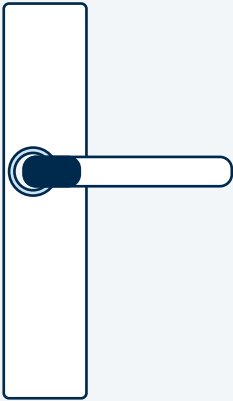

Wide

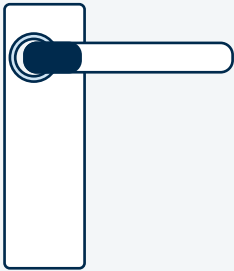

Short

STEP 3

Measure the door thickness of every door that will be equipped with digital door fittings.

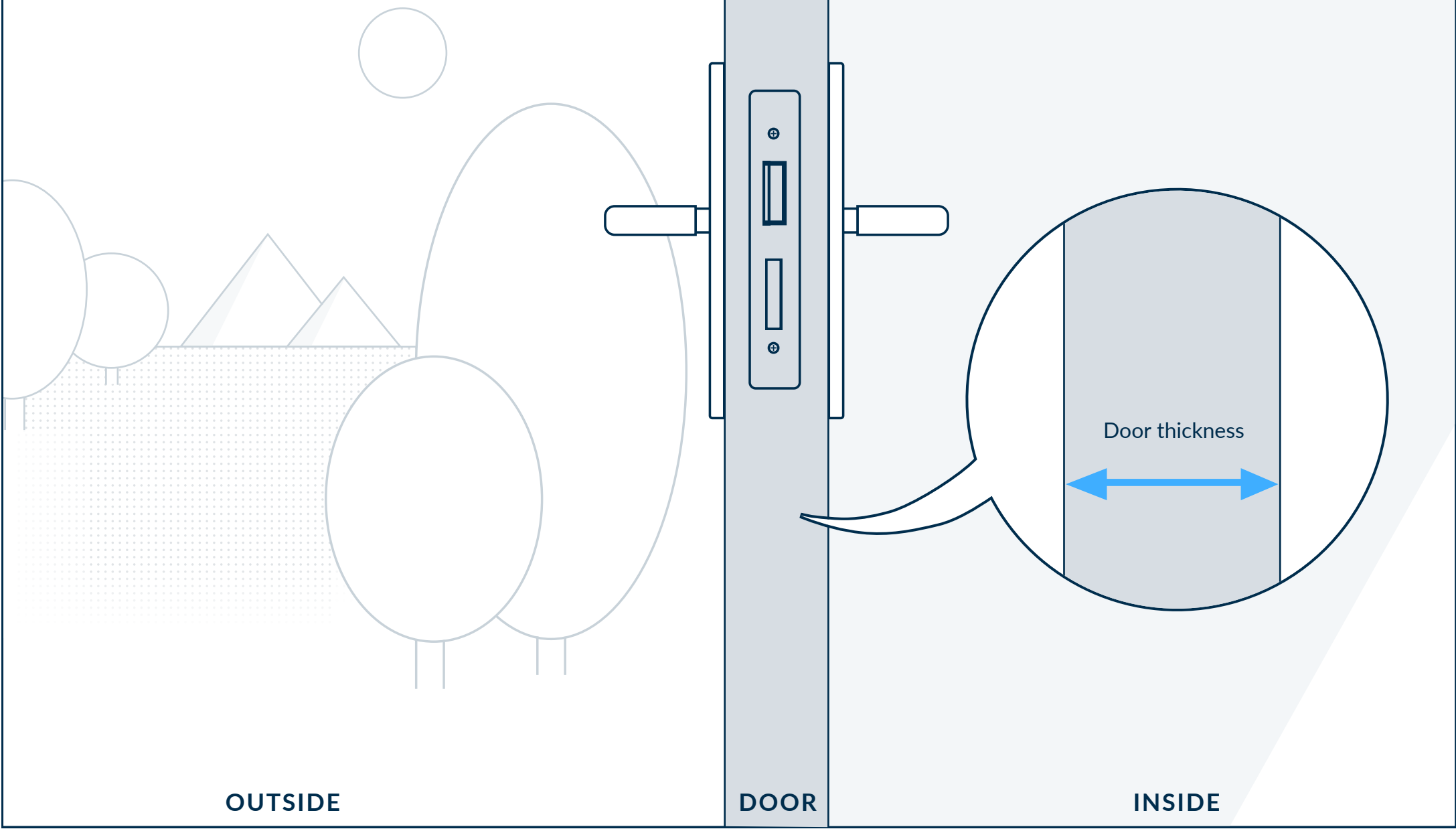

STEP 4

Dismount the door handle in order to measure the size of square pin.

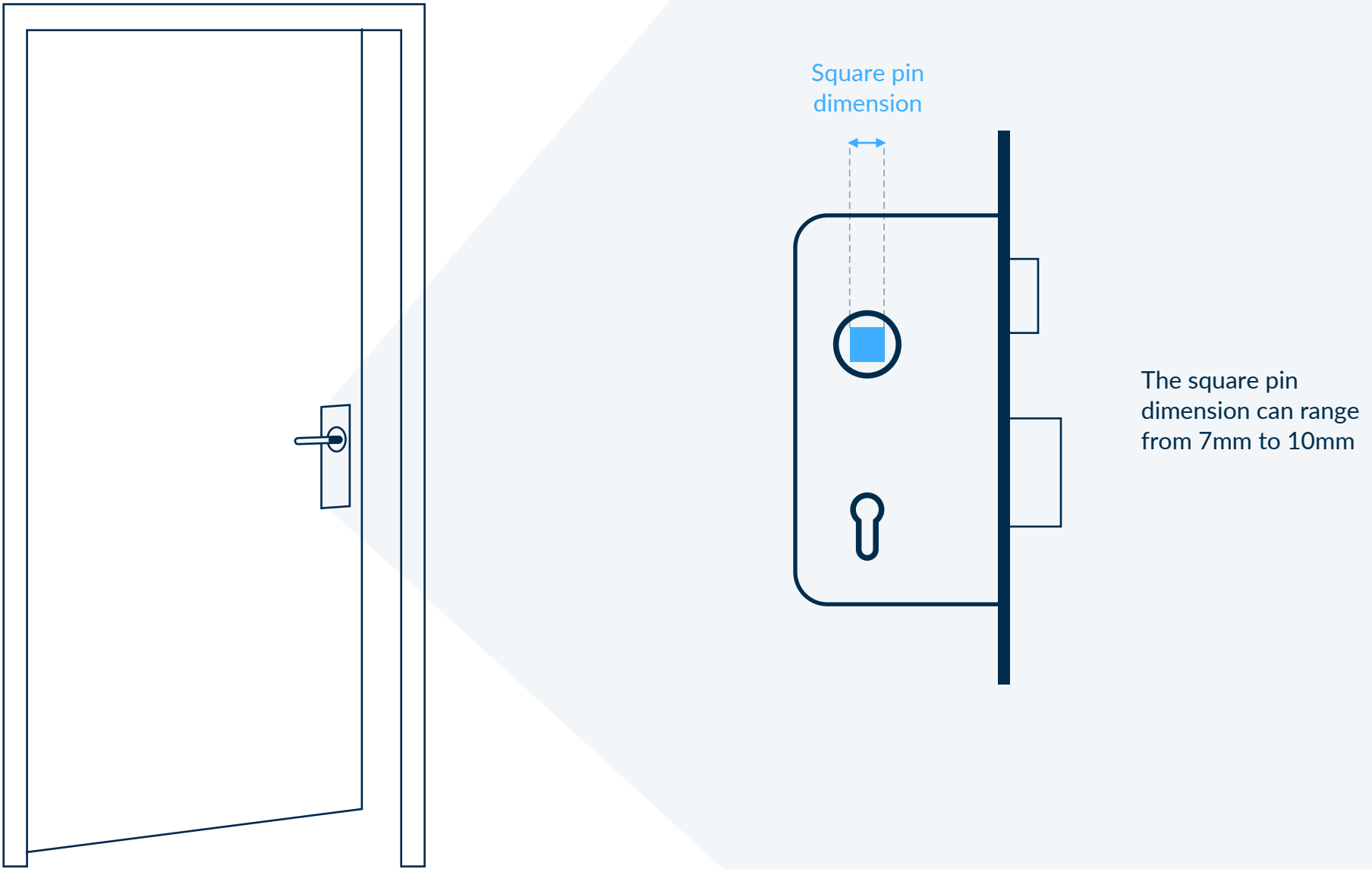

STEP 5

Measure the distance dimension: middle of spindle hole to middle of cylinder.

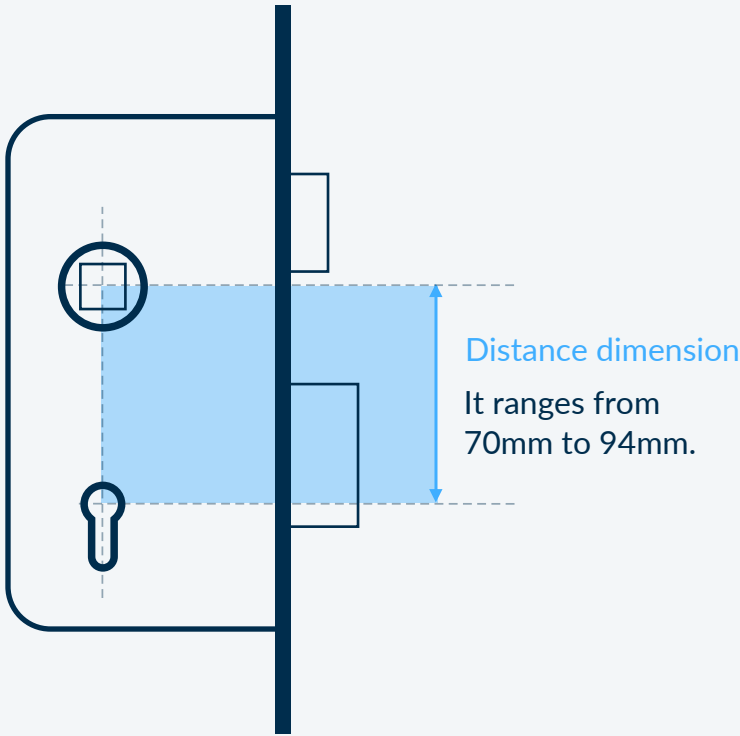
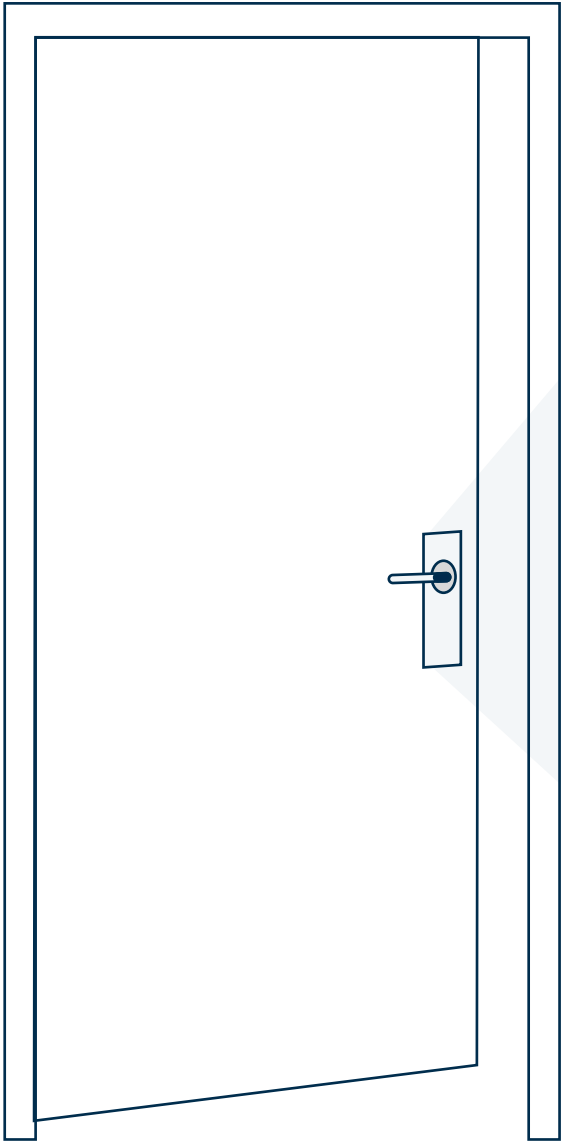

STEP 6

Provide the type of key hole.

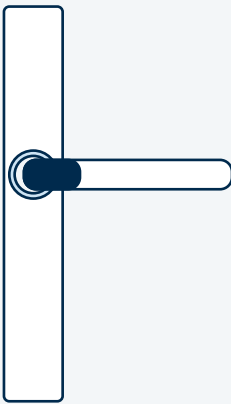
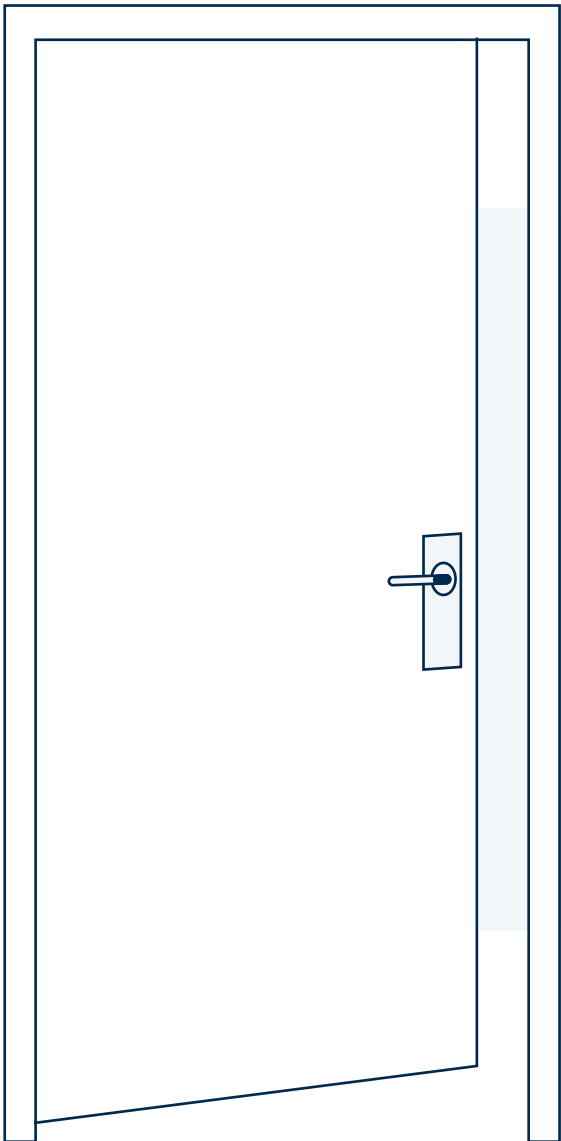

Dummy cylinder

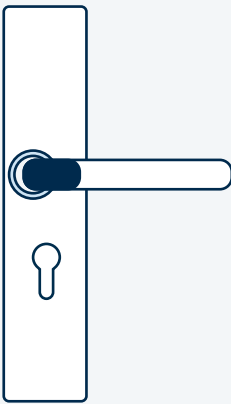

Profile cylinder pc



Round cylinder pc22

STEP 7

Provide the type of borehole.

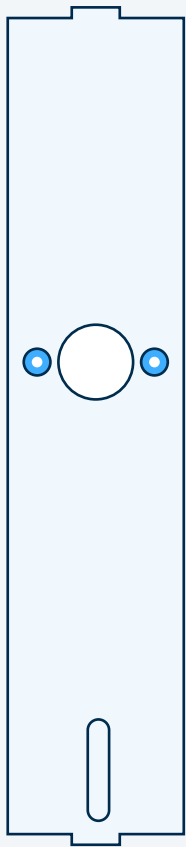
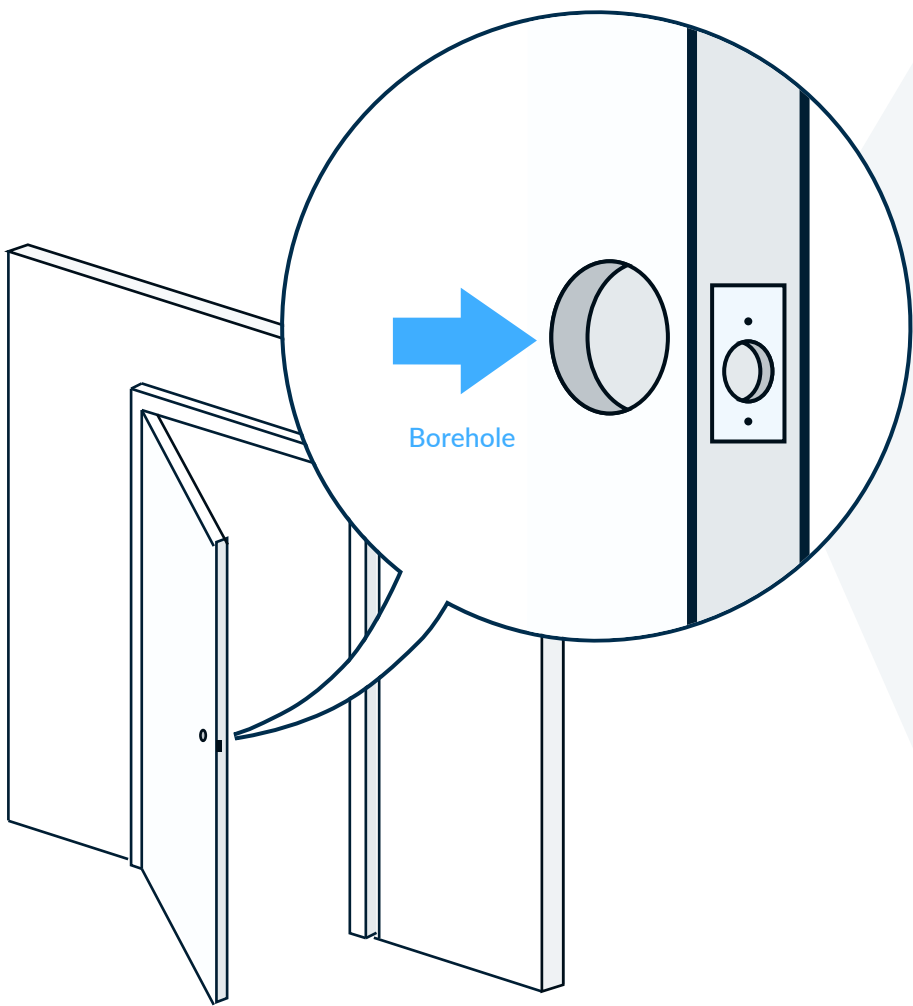

Rosette borehole  
(wide)

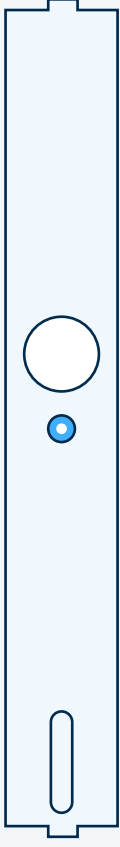

Upper short plate  
borehole (slim)

STEP 8

Choose the shape of the door opener.  
Different versions are available, for example  
door openers in L-shape or in U-shape.

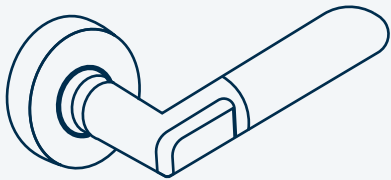

L1 Shape  
For all doors

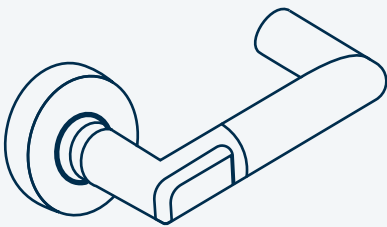

U1 Shape  
For emergency doors

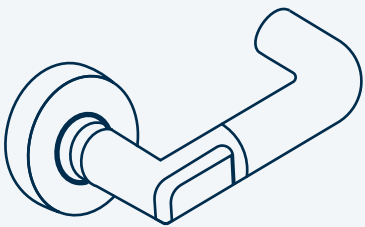

U2 Shape  
For emergency doors

STEP 9

Specify if the door is placed on the outside or if it stays inside the building.

OUTSIDE  
DOOR

INSIDE  
DOOR

STEP 10

Please fill in the information from STEP 1 to 9 in the door handle & fitting configurator and send it to Sensorberg.

You can find the table here: [documents.sensorberg.com](https://documents.sensorberg.com)

Or just ask your Sensorberg Sales or Delivery Manager.

OUTSIDE  
DOOR

INSIDE  
DOOR